

How To...do Firmware Updates

All Kelvin lighting fixtures are designed to make it easy to perform firmware (FW) updates through the Kelvin Narrator App.

Firmware update steps.



1. Download the Kelvin Narrator App, available through the Apple App Store and the Google Play Store



<https://apps.apple.com/de/app/kelvin-narrator/id1606875885?l=en>



<https://play.google.com/store/apps/details?id=com.riftlabs.kelvinapp&gl=DE>

2. If the app is already installed, make sure it is up to date to have the latest FW version for your Kelvin lighting fixture.
3. Start the Narrator app and connect to the Play (pressing  than ).

NOTE : Make sure that the battery is at least 50% charged or connected to a suitable USB-C PD (Power Delivery 2.0 or higher).

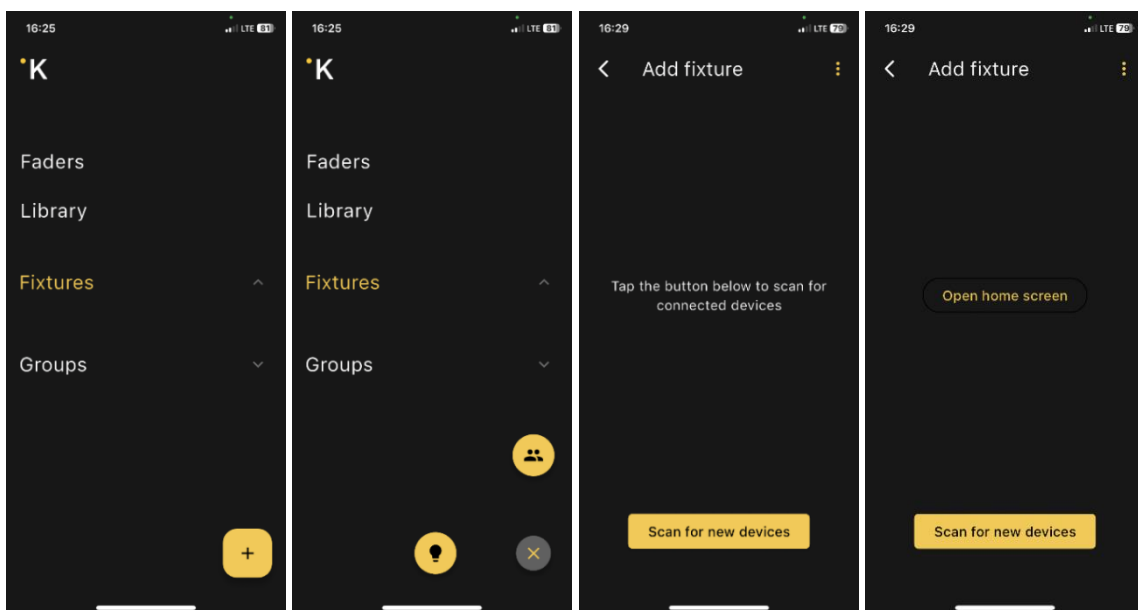

- Once connected, the app will automatically check the FW version of the connected and selected (active) device to give the option to update the FW if a newer version is available; if the latest one is already installed the related message is displayed.

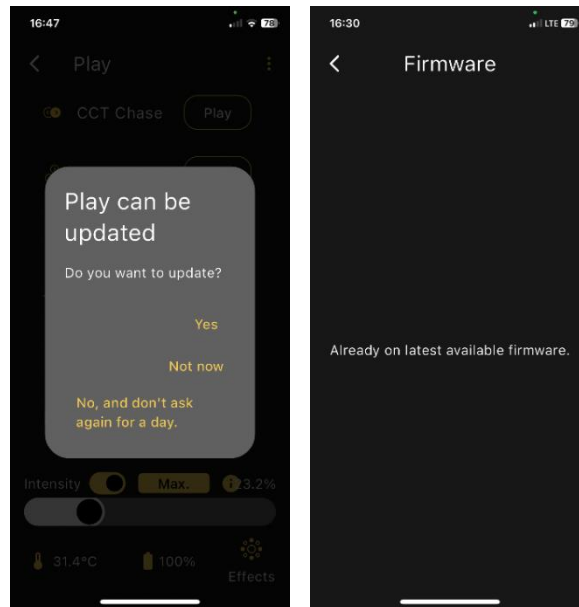

- Press “Yes”, and uploading the new FW starts. This step will take a moment.
- Once the upload is done, the fixture will finalize the FW update process and reboot (Play series display is off, Epos series display shows status) - and is ready to use.

NOTE : Do not push any button or encoder, do not switch off the fixture, do not unplug mains cable for power (Epos series) or plug/unplug the charger (Play series).

- It is recommended to check out the *About Screen* to see FW version.

From Norway with best regards

Team Kelvin